



**MFC**

**SERIE 101**





**PRESCRIPCIONES TÉCNICAS: SERIE 101**

Temperatura máxima

- Nitrilo (N) -20°C + 100°C (- 4°F + 212°F)
- FPM (V) -20°C + 180°C (- 4°F + 356°F)



Presión máxima

- MFC 101.06 16 bar
- MFC 101.09 16 bar
- MFC 101.12 16 bar
- MFC 101.16 16 bar
- MFC 101.20 16 bar
- MFC 101.25 16 bar

Paso interno

- MFC 101.06 6 mm
- MFC 101.09 9 mm
- MFC 101.12 12 mm
- MFC 101.16 16 mm
- MFC 101.20 20 mm
- MFC 101.25 25 mm

Materiales enchufe estandar

- Cuerpo del enchufe Latón
- Tirador Acero Inoxidable AISI 420
- Válvula Latón
- Muelle Acero Inoxidable
- Juntas Viton FPM

Aplicaciones

- Procesos de regulación de temperatura con agua fría o caliente, aceite, etc.
- Procesos de inyección de plástico
- Líneas de vapor



**GRÁFICO DE CAUDAL VS CAÍDA DE PRESIÓN: SERIE 101**

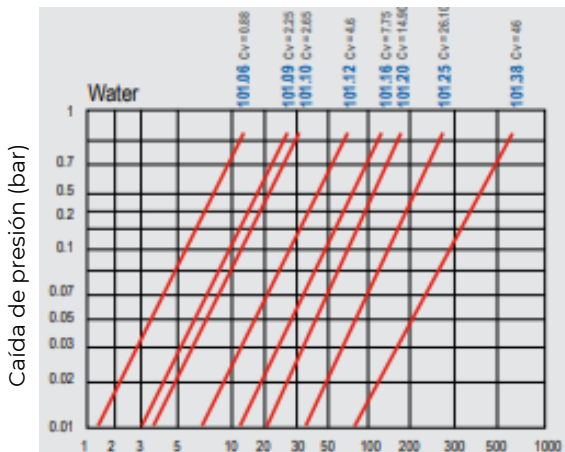

Velocidad del fluido 5 m/s.

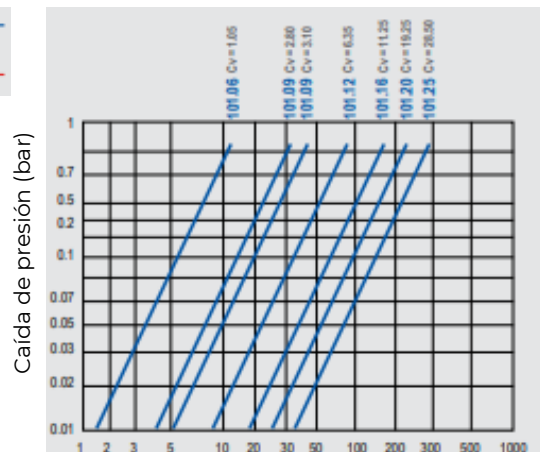
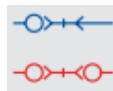

Velocidad del fluido 5 m/s.



**ENCHUFE HEMBRA ESPIGA MANGUERA**



Enchufe hembra serie 101

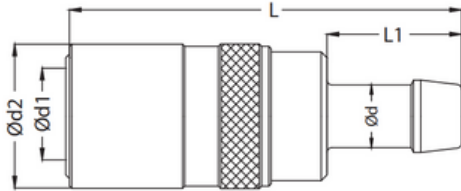

DN	Con válvula	Sin válvula	Ød	L
6	S 101.06 SHB 06	S 101.06 SHF 06	6 mm	60
	S 101.06 SHB 08	S 101.06 SHF 08	8 mm	60
9	S 101.09 SHB 10	S 101.09 SHF 10	10 mm	69
	S 101.09 SHB 12	S 101.09 SHF 12	12 mm	69
12	S 101.12 SHB 12	S 101.12 SHF 12	12 mm	81.5
	S 101.12 SHB 16	S 101.12 SHF 16	16 mm	87
16	S 101.16 SHB 16	S 101.16 SHF 16	16 mm	108
	S 101.16 SHB 19	S 101.16 SHF 19	19 mm	108



**ENCHUFE HEMBRA ESPIGA 90°**



Enchufe hembra serie 101

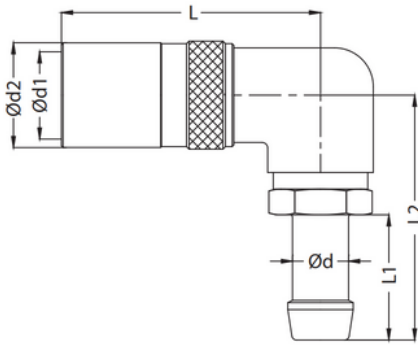

DN	Con válvula	Sin válvula	Ød	L
6	S 101.06 SHB 08-90	S 101.06 SHF 08-90	6 mm	60
9	S 101.09 SHB 10-90	S 101.09 SHF 10-90	10 mm	69
	S 101.09 SHB 12-90	S 101.09 SHF 12-90	12 mm	69
12	S 101.12 SHB 12-90	S 101.12 SHF 12-90	12 mm	81.5
	S 101.12 SHB 16-90	S 101.12 SHF 16-90	16 mm	87
16	S 101.16 SHB 16-90	S 101.16 SHF 16-90	16 mm	108
	S 101.16 SHB 19-90	S 101.16 SHF 19-90	19 mm	108



**ENCHUFE HEMBRA ROSCA HEMBRA**



Enchufe hembra serie 101

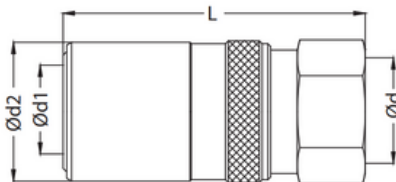

DN	Con válvula	Sin válvula	Ød	L
6	S 101.06 SFB 13	S 101.06 SFF 13	BSP 1/4	46
9	S 101.09 SFB 17	S 101.09 SFF 17	BSP 3/8	53
12	S 101.12 SFB 21	S 101.12 SPF 21	BSP 1/2	81.5
16	S 101.12 SFB 26	S 101.12 SFF 26	BSP 3/4	90



**ENCHUFE HEMBRA ESPIGA PUSHLOCK**



Enchufe hembra serie 101

DN	Con válvula	Sin válvula	Ød	L
6	S 101.06 SPB 10	S 101.06 SPF 10	10 mm	61
9	S 101.09 SPB 10	S 101.09 SPF 10	10 mm	66
	S 101.09 SPB 13	S 101.09 SPF 13	13 mm	81.5
12	S 101.12 SPB 13	S 101.12 SPF 13	13 mm	81.5
	S 101.12 SPB 16	S 101.12 SPF 16	16 mm	91.5
16	S 101.16 SPB 19	S 101.16 SPF 16	19 mm	113

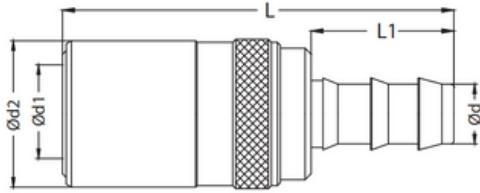

**ENCHUFE HEMBRA ESPIGA PUSHLOCK 90°**



Enchufe hembra serie 101

DN	Con válvula	Sin válvula	Ød	L
6	S 101.06 SPB 10-90	S 101.06 SPF 10-90	10 mm	60
9	S 101.09 SPB 10-90	S 101.09 SPF 10-90	10 mm	69
	S 101.09 SPB 13-90	S 101.09 SPF 13-90	13 mm	69
12	S 101.12 SPB 13-90	S 101.12 SPF 13-90	13 mm	84
	S 101.12 SPB 16-90	S 101.12 SPF 16-90	16 mm	94
16	S 101.16 SPB 19-90	S 101.16 SPF 19-90	19 mm	114

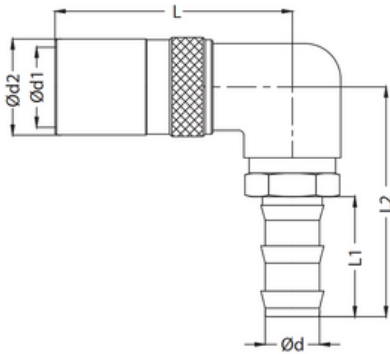

**ENCHUFE HEMBRA ROSCA MACHO**



Enchufe hembra serie 101

DN	Con válvula	Sin válvula	Ød	L
6	S 101.06 SOB 13	S 101.06 SOF 13	BSP 1/4	46
9	S 101.09 SOB17	S 101.09 SOF 17	BSP 3/8	53
12	S 101.12 SOB 21	S 101.12 SOF 21	BSP 1/2	67
16	S 101.16 SOB 26	S 101.16 SOF 26	BSP 3/4	90.5

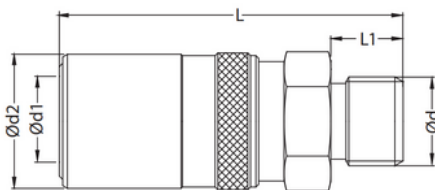

**ENCHUFE MACHO ROSCA MACHO**

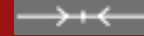

Enchufe macho serie 101

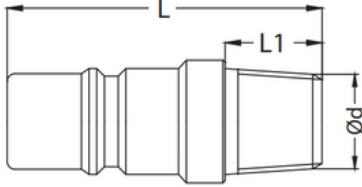

DN	Sin válvula	Ød	L
6	S 101.06 PRF 10	BSPT 1/8	30
	S 101.06 PRF 13	BSPT 1/4	31
9	S 101.09 PRF 13	BSPT 1/4	34
	S 101.09 PRF 17	BSPT 3/8	36
	S 101.09 PRF 21	BSPT 1/2	42
12	S 101.12 PRF 17	BSPT 3/8	39
	S 101.12 PRF 21	BSPT 1/2	45
16	S 101.16 PRF 26	BSPT 3/4	63

**ENCHUFE MACHO ROSCA HEMBRA**



Enchufe macho serie 101

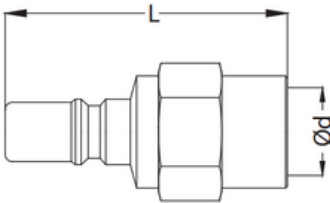

DN	Sin válvula	Ød	L
6	S 101.06 PFF 13	BSPT 1/4	34
9	S 101.09 PFF 13	BSPT 1/4	37
	S 101.09 PFF 17	BSPT 3/8	47
12	S 101.12 PFF 21	BSPT 1/2	45
16	S 101.16 PFF 26	BSPT 3/4	58

**ENCHUFE MACHO ESPIGA PUSHLOCK**



Enchufe macho serie 101

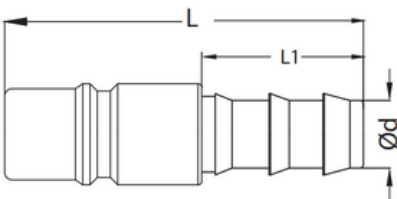

DN	Sin válvula	Ød	L
6	S 101.06 PPF 10	10 mm	45
9	S 101.09 PPF 10	10 mm	46
	S 101.09 PPF 13	13 mm	50
12	S 101.12 PPF 16	16 mm	67
16	S 101.16 PPF 19	19 mm	73



**ENCHUFE MACHO ESPIGA MANGUERA**



Enchufe macho serie 101

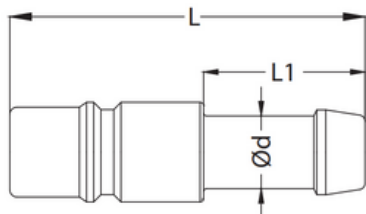

DN	Sin válvula	Ød	L
6	S 101.06 PHF 08	8 mm	44
9	S 101.09 PHF 12	12 mm	50
12	S 101.12 PHF 16	16 mm	62
16	S 101.16 PHF 19	19 mm	70



**ENCHUFE MACHO ROSCA MACHO**



Enchufe macho serie 101

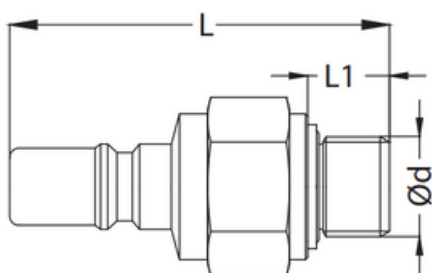

DN	Con válvula	Ød	L
6	S 101.06 POB 10	BSPT 1/8	45
	S 101.09 POB 13	BSPT 1/4	45
9	S 101.09 POB 13	BSPT 1/4	51
	S 101.09 POB 17	BSPT 3/8	48
12	S 101.12 POB 17	BSPT 3/8	59
	S 101.12 POB 21	BSPT 1/2	63
16	S 101.16 POB 26	BSPT 3/4	81



**ENCHUFE MACHO ROSCA HEMBRA**



Enchufe macho serie 101

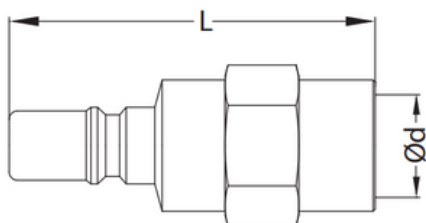

DN	Con válvula	Ød	L
6	S 101.09 PFB 13	BSPT 1/4	47
9	S 101.09 PFB 13	BSPT 1/4	49
	S 101.09 PFB 17	BSPT 3/8	49
12	S 101.12 PFB 21	BSPT 1/2	63
16	S 101.16 PFB 26	BSPT 3/4	81



**ENCHUFE HEMBRA ROSCA HEMBRA**



Enchufe hembra serie 101

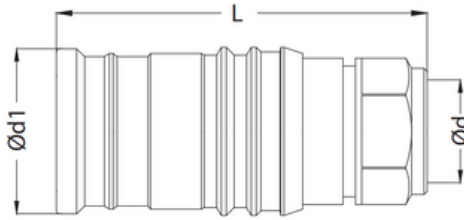

DN	Con válvula	Ød	L
20	S 101.20 SFB 26	BSP 3/4	119
	S 101.20 SFB 33	BSP 1	120
25	S 101.25 SFB 33	BSP 1	142
	S 101.25 SFB 42	BSP 1-1/4	142



**ENCHUFE HEMBRA ROSCA MACHO**



Enchufe hembra serie 101

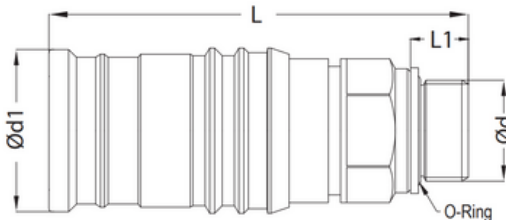

DN	Con válvula	Ød	L
20	S 101.20 SOB 26	BSP 3/4	133
	S 101.20 SOB 33	BSP 1	142
25	S 101.25 SOB 33	BSP 1	142
	S 101.25 SOB 42	BSP 1-1/4	167



**ENCHUFE MACHO ROSCA HEMBRA**



Enchufe macho serie 101

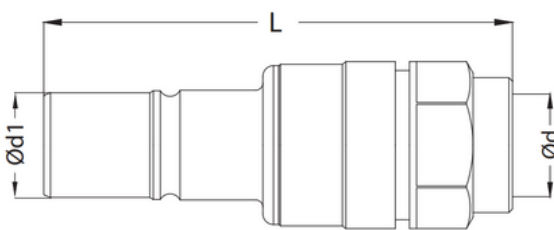

DN	Con válvula	Ød	L
20	S 101.20 PFB 26	BSP 3/4	126,5
	S 101.20 PFB 33	BSP 1	126,5
25	S 101.25 PFB 33	BSP 1	148,5
	S 101.25 PFB 42	BSP 1-1/4	148,5



**ENCHUFE MACHO ROSCA MACHO**



Enchufe macho serie 101

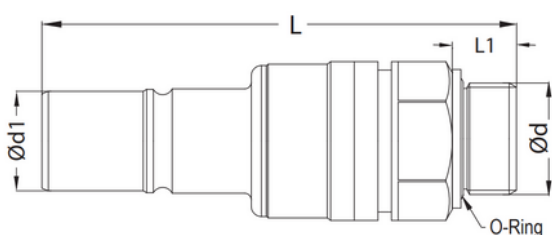

DN	Con válvula	Ød	L
20	S 101.20 POB 26	BSP 3/4	141
	S 101.20 POB 33	BSP 1	141
25	S 101.25 POB 33	BSP 1	151
	S 101.25 POB 42	BSP 1-1/4	151